

Spare Parts Catalogue

OSSA *máquinas* **pioneer**

250 AE-71 ENDURO

**MODEL
250 AE-71**

ENGINE

1st. LIST

| Part Number | DESCRIPTION | Quanti. | Valid from unit n° | Part Number | DESCRIPTION | Quanti. | Valid from unit n° | Part Number | DESCRIPTION | Quanti. | Valid from unit n° |
|------------------|--------------------------------|---------|--------------------|-----------------|-------------------------------|---------|--------------------|---------------|--|---------|--------------------|
| 121.001 MI | Engine assembly | 1 | | 121.107 | Gear 1 st. lay shaft | 1 | | 991.516 M | Chain primary | 1 | |
| 33.176 I-II-IV | Shim washer lay shaft | — | | 121.108 | Gear 2 nd. lay shaft | 1 | | 991.605 | Locating dowel engine case | 1 | |
| 33.292 I-II-IV-X | Shim washer lay shaft | — | | 121.109 | Gear 3 rd. lay shaft | 1 | | 991.608 | Gasket center case | 1 | |
| 50.404 I-II-IV-X | Shim washer selector | — | | 121.110 | Shifting fork 1 st. and 3 rd. | 1 | | 991.607 | Gasket clutch cover | 1 | |
| 50.659 | Washer stop bolt kick | 1 | | 121.111 | Shifting fork 2 nd. | 1 | | 991.608 | Anchor pin | 1 | |
| 101.019 | Stop bolt kick | 1 | | 121.112 | Shifting fork 4 th. and 5 th. | 1 | | 991.609 | Inspection cover | 1 | |
| 102.005 | Wristpin | 1 | | 121.113 | Spacer 5 th. gear | 1 | | 991.610 | Inspection cover gasket | 1 | |
| 111.004 MI | Connecting rod assembly | 1 | | 121.114 | Shifting fork shaft | 1 | | 991.611 | Grommet rubber | 1 | |
| 111.004 | Connecting rod | 1 | | 121.115 | Spring selector | 1 | | 991.612 B | Tube breather | 1 | |
| 111.009 | Cylinder gasket | 1 | | 121.116 | Footshift lever | 1 | | 991.615 | Screw engine cover primary side | 1 | |
| 111.010 M | Crankshaft assembly | 1 | | 121.117 | Washer 1 st. gear | 1 | | 991.701 | Ratchet Kickstarter | 1 | |
| 111.010 | Flywheel clutch side | 1 | | 121.120 M | Needle brg. 1 st. gear | 1 | | 991.703 | Spring | 1 | |
| 111.011 | Flywheel magneto | 1 | | 121.124 M | Selector body assembly | 1 | | 991.704 | Washer kickstarter spring | 2 | |
| 111.017 | Stud, carburettor | 2 | | 121.125 | Dust cover selector shaft | 2 | | 991.706 | Circlip kickstarter shaft | 1 | |
| 111.018 | Stud, cylinder head | 4 | | 121.126 | Plug selector shaft | 1 | | 991.707 | Stop kickstarter spring | 1 | |
| 111.019 | Nut, intake manifold | 2 | | 121.127 M | Selector shaft assembly | 1 | | 991.708 | Spring kickstarter engage | 1 | |
| 111.076 | Thrust washer | 1 | | 121.128 | Washer selector shaft spring | 1 | | 991.709 | Thrust washer kickstarter shaft | 1 | |
| 111.077 | Spacer | 1 | | 121.175 | Shaft Kickstarter | 1 | | 991.710 | Thrust washer kickstarter gear | 1 | |
| 111.078 M | Needle brg | 1 | | 121.177 MI | Kickstarter lever assembly | 1 | | 991.717 | Spring, lever pin | 1 | |
| 111.079 | «O» ring | 1 | | 121.177 | Kickstarter lever | 1 | | 991.718 | Pin kick lever | 1 | |
| 111.080 M | Clutch hub assembly | 1 | | 121.200 M | Engine cases assembly | 1 | | | | | |
| 111.081 | Clutch plate inner | 1 | | 121.202 | Clutch cover | 1 | | | | | |
| 111.082 M | Clutch plate outer | 1 | | 121.203 M | Magneto cover | 1 | | | | | |
| 111.083 M | Clutch hub assembly | 1 | | 121.206 | Bushing | 2 | | | | | |
| 111.085 | Cup clutch spring | 5 | | 911.131 | Nut cylinder head | 4 | | | | | |
| 111.086 | Clutch spring | 5 | | 911.139 II-IV-X | Shim washer | — | | | | | |
| 112.018 | Gasket manifold | 1 | | 911.246 | Rubber footshift lever | 1 | | | | | |
| 112.112 | Countershaft sprocket | 1 | | 911.514 B | Slotted nut clutch spring | 5 | | | | | |
| 112.116 M | Needle brg cage 5 th. gear | 2 | | 911.604 | Drain plug | 1 | | | | | |
| 112.175 | Kickstarter driving gear | 1 | | 911.609 C | Locating dowel | 4 | | | | | |
| 112.181 B | Kick lever suport | 1 | | 911.611 | Bolt, engine cases | 15 | | | | | |
| 112.182 | Support kick lever ring | 1 | | 911.614 | Screw | 4 | | | | | |
| 112.183 | Spring washer lever | 1 | | 911.617 | Gasket drain plug | 1 | | | | | |
| 114.008 | Cage big end bearing | 1 | | 912.604 | Washer selector shaft | 1 | | | | | |
| 114.009 | Roller big end bearing | 14 | | 921.111 | Shim washer main shaft 0,05 | — | | | | | |
| 114.081 | Nut magneto flywheel | 1 | | 921.112 | Shim washer main shaft 0,1 | — | | | | | |
| 118.051 M | Cylinder assembly | 1 | | 921.113 | Shim washer main shaft 0,2 | — | | | | | |
| 118.051 MS-20 | Cylinder Assembly 1st oversize | 1 | | 921.617 | Washer | 1 | | | | | |
| 118.052 | Cylinder sleeve | 1 | | 941.205 | Circlip | 5 | | AB-80 | Spring washer engine case | 1 | |
| 118.053 MI | Piston assembly | 1 | | 941.209 | Spacer countershaft sprocket | 1 | | ACF-80 | Washer oil level screw | 1 | |
| 118.053 S-20 MI | Piston assembly 1st oversize | 1 | | 941.242 | Washer countershaft sprocket | 1 | | AF-150 | Washer magneto | 1 | |
| 118.053 S-40 MI | Piston assembly 2nd oversize | 1 | | 942.167 | Nut stop bolt | 1 | | AG-60 | Lock washer clutch arm, inspection cover | 3 | |
| 118.053 S-60 MI | Piston assembly 3rd oversize | 1 | | 981.105 M | Rod stop bolt | 1 | | AG-160 | Washer cush drive hub | 2 | |
| 118.053 | Piston | 1 | | 991.107 B | Rod brg. cage | 1 | | AN-120 | Flat washer | 1 | |
| 118.053 S-20 | Piston 1st oversize | 1 | | 991.109 B | Crankshaft pin | 1 | | ASe-100 | Snap ring fork shaft | 2 | |
| 118.053 S-40 | Piston 2nd oversize | 1 | | 991.112 | Piston circlip | 2 | | ASe-110 | Snap ring selector | 1 | |
| 118.053 S-60 | Piston 3rd oversize | 1 | | 991.119 | Engine sprocket | 1 | | ASe-180 | Snap ring selector and kickstarter | 2 | |
| 118.054 | Piston ring | 2 | | 991.120 | Shaft cush drive | 1 | | AT-60 | Clutch arm washer | 1 | |
| 118.054 S-20 | Piston ring 1st oversize | 1 | | 991.121 | Coupling cush drive | 1 | | AT-70 | Carburettor mounting washer | 2 | |
| 118.054 S-40 | Piston ring 2nd oversize | 1 | | 991.122 | Stop spring | 1 | | AT-80 | Washer head and engine case | 5 | |
| 118.054 S-60 | Piston ring 3rd oversize | 1 | | 991.123 | Spring cush drive | 1 | | R-555 | Clutch rod ball | 1 | |
| 118.057 | Cylinder head | 1 | | 991.139 II-IV-X | Allen nut, cush drive | 1 | | CA-10.015 | Clutch bolt cotter pin | 5 | |
| 118.058 | Gasket cylinder head | 1 | | 991.140 | Shim washer | — | | CE-30.022 | Kick suport pin | 1 | |
| 118.068 | Compression release plug | 1 | | 991.141 | Right main brg. | 1 | | FE-60 | Clutch arm nut | 1 | |
| 118.069 | Compression release gasket | 1 | | 991.211 | Left main brg. | 1 | | FE-80 | Nut clutch and engine case | 2 | |
| 118.097 MI | Magneto assembly | 1 | | 991.214 | Selector fork | 1 | | KC-17-47-14 | Gearbox bearing | 1 | |
| 121.005 | Stud, protection tube | 4 | | 991.215 | Nut countershaft sprocket | 1 | | KC-25-52-15 | Gearbox bearing | 1 | |
| 121.016 MI | Carburettor | 1 | | 991.216 | Spring stop selector | 2 | | SG-25-42-8 DL | Oil seal | 2 | |
| 121.022 MI | Spark plug | 1 | | 991.228 | Oil seal | 1 | | SG-29-40-7 DL | Oil seal | 1 | |
| 121.077 | Nut clutch hub | 1 | | 991.228 | Spring | 1 | | SO-139-26 | «O» ring selector shaft | 2 | |
| 121.078 | Clutch rod | 2 | | 991.231 | Guide selector | 1 | | SO-178-26 | «O» ring kickstarter | 1 | |
| 121.079 M | Clutch arm assembly | 1 | | 991.232 | Anchor pin selector | 1 | | TE-60.020 | Bolt gear lever | 1 | |
| 121.100 | Main shaft | 1 | | 991.232 | Spring | 1 | | TE-70.025 | Bolt kickstarter lever | 1 | |
| 121.101 | Gear 2 nd. main shaft | 1 | | 991.234 | Washer selector shaft | 1 | | TE-80.040 | Engine bolt | 1 | |
| 121.102 | Gear 3 rd. main shaft | 1 | | 991.235 | Retaining ring | 1 | | TL-50.015 | Screw magneto back-plate | 3 | |
| 121.103 | Gear 4 th. main shaft | 1 | | 991.502 | Clutch plate | 5 | | TL-60.012 | Clutch, cover and oil level bolt | 3 | |
| 121.104 | Gear 5 th. main shaft | 1 | | 991.503 CM | Clutch plate | 5 | | TS-60.022 | Engine case bolt | 2 | |
| 121.105 | Dog wheel 4 th. and 5 th. gear | 1 | | 991.512 | Plunger clutch arm | 1 | | TS-60.075 | Bolt magneto cover | 1 | |
| 121.106 | Lay shaft | 1 | | 991.513 | Clutch regulating screw | 1 | | TS-60.080 | Bolt magneto cover | 2 | |
| | | | | 991.514 | Clutch cam | 1 | | XR-30.013 | Magneto key | 1 | |

COMMON PARTS

| EDITION | | | |
|---------|--|--|--|
| 1 | | | |
| 9-70 | | | |

| MODEL 250 AE-71 | | FRAME | | | | | | | | | | 2nd. LIST | |
|--------------------|---|--------|---------------------|---------------|---------------------------------|--------|---------------------|-------------|-------------------------|---|---------------------|-----------|--|
| Part Number | DESCRIPTION | Quant. | Valid from unit n°* | Part Number | DESCRIPTION | Quant. | Valid from unit n°* | Part Number | DESCRIPTION | Quant. | Valid from unit n°* | | |
| 13.714 | Washer, engine protector, rear fender, gas tank | 12 | | 118.820 | Mount handlebar | 2 | | | COMMON PARTS | | | | |
| 101.457 | Bolt rear wheel adjuster | 2 | | 118.821 | Handlebar clamp | 2 | | | | | | | |
| 112.400 Cd | Right front footpeg | 1 | | 118.822 | Bolt, handlebar | 4 | | AB-80 | | Spring washer | 2 | | |
| 112.400 Ci | Left front footpeg | 1 | | 118.845 | Spark plug labbel (Handlebar) | 1 | | AB-100 | | Spring washer | 2 | | |
| 112.402 B | Footpeg shaft | 2 | | 118.849 | Regulation labbel (Handlebar) | 1 | | AF-120 | | Washer swing arm | 2 | | |
| 112.471 | Swing arm axle | 1 | | 118.900 M | Seat | 1 | | AG-60 | | Washer engine protector, and fenders | 12 | | |
| 112.472 | Bushing, swing arm | 2 | | 118.902'M (*) | Seat mount | 1 | | | | | | | |
| 112.473 | Bolt, chain guide | 2 | | 118.904 | Gasket seat mount | 1 | | AG-80 | | Washer chain guide | 1 | | |
| 112.474 | Bolt, swing arm | 2 | | 121.300 M | Frame 250 cc. | 1 | | AG-120 | | Washer passenger footpegs | 2 | | |
| 112.485 | Spacer chain guide | 1 | | 121.310 M | Frame 175 cc. | 1 | | AN-60 | | Washer plastic shell | 4 | | |
| 112.486 | Pin chain guide | 1 | | 121.320 | Bolt engine | 2 | | AN-120 | | Washer petcock | 2 | | |
| 112.492 | Rubber plug swing arm | 1 | | 121.321 | Engine protector | 1 | | AT-40 | | Washer | 2 | | |
| 112.725 | Fuel line right | 1 | | 121.322 | Rubber plate | 1 | | AT-60 | | Washer fenders, shell, and seat | 15 | | |
| 112.726 B | Fuel line left | 1 | | 121.400 M | Passenger footpeg | 2 | | AT-80 | | Washer engine, chain guide, fenders and chain guard | 10 | | |
| 112.750 | Chain guard | 1 | | 121.425 M | Side stand assembly | 1 | | AT-100 | | Engine washer | 2 | | |
| 112.762 | Enduro decal | 1 | | 121.429 | Side stand axle | 1 | | AT-120 | | Washer passenger footpegs | 2 | | |
| 112.800 B | Brake pedal | 1 | | 121.450 M | Swing arm assembly | 1 | | CA-20.015 | | Cotter pin brake arm | 1 | | |
| 112.829 dM | Right cables dust protector | 1 | | 121.482 | Rear bracket chain guide | 1 | | CA-20.022 | | Cotter pin side stand shaft | 1 | | |
| 112.829 iM | Left cables dust protector | 1 | | 121.483 | Bolt chain guide | 1 | | FE-40 | | Nut | 2 | | |
| 112.905 | Seat nut | 2 | | 121.705 | Side grip | 1 | | FE-60 | | Nut fenders and shell | 10 | | |
| 114.830 MI | Clutch lever assembly | 1 | | 121.710 | Auxiliary rear fender | 1 | | FE-70 | | Nut adjusting bolt | 2 | | |
| 114.831 MI | Brake lever assembly | 1 | | 121.720 | Clip fuel line | 4 | | FE-80 | | Nut engine mount, chain guide, and rear fender | 5 | | |
| 118.318 | Specifications labe (Frame) | 1 | | 121.760 M | Plastic shell | 1 | | | | Nut rear engine mount | 2 | | |
| 118.488 | Front bracket chain guide | 1 | | 121.762 M | Carburettor dust cover, 250 cc. | 1 | | FE-100 | | Bolt auxiliary fender | 3 | | |
| 118.507 | Washer handlebar bolt | 4 | | 121.776 M | Carburettor dust cover, 175 cc. | 1 | | TE-60.010 | | Bolt engine protector, gas tank and shell | 8 | | |
| 118.701 | Front fender mount | 1 | | 121.826 MI | Twistgrip assembly | 1 | | TE-60.015 | | Bolt rear fender | 4 | | |
| 118.702 (*) | Fender front | 1 | | 917.206 B | Rubber grip throttle | 1 | | | | Bolt front fender | 4 | | |
| 118.705 M (*) | Fender rear | 1 | | 917.207 B | Rubber grip handlebar | 1 | | TE-60.025 | | Bolt brake pedal | 1 | | |
| 118.720 BM (*) | Gas tank | 1 | | 918.118 M | Petcock assembly | 2 | | TE-60.042 | Bolt chain guard | 1 | | | |
| 118.724 | Tube breather | 1 | | 918.214 B | Gas cap | 1 | | TE-60.028 | Bolt rear fender | 1 | | | |
| 118.725 | Tank badge OSSA | 2 | | 918.215 B | Rubber seal | 1 | | TE-80.015 | Bolt rear fender | 1 | | | |
| 118.726 | Bolt, tank badge | 4 | | 918.231 | Footpeg nut | 2 | | TE-80.018 | Bolt passenger footpegs | 2 | | | |
| 118.727 | Rubber washer tank mount | 2 | | 932.518 | Washer brake pedal | 1 | | TE-80.025 | Bolt | 2 | | | |
| 118.728 | Rubber rest, gas tank | 1 | | 958.011 | Washer rear fender | 2 | | TL-40.014 | Bolt shell and seat | 6 | | | |
| 118.743 | Decal 250 cc. | 1 | | 992.121 | Bushing brake shaft | 2 | | TL-60.012 | | | | | |
| 118.745 | Decal 175 cc. | 1 | | 992.141 | Engine mounting bolt | 2 | | | | | | | |
| 118.765 M | Tool box cover | 1 | | 992.301 M | Rear brake lever assembly | 1 | | | | | | | |
| 118.766 | Mount tool box cover | 2 | | 992.304 | Clevis pin rear brake | 1 | | | | | | | |
| 118.818 M | Handlebar | 1 | | 992.307 | Brake pedal return spring | 1 | | | | | | | |
| | | | | 992.355 | Side stand spring | 1 | | | | | | | |

(*) When ordering these parts, please specify the color

| EDITION | | | | |
|---------|--|--|--|--|
| 1 | | | | |
| 9-70 | | | | |

| EDITION | | | | |
|---------|--|--|--|--|
| 1 | | | | |
| 9-70 | | | | |

FRAME

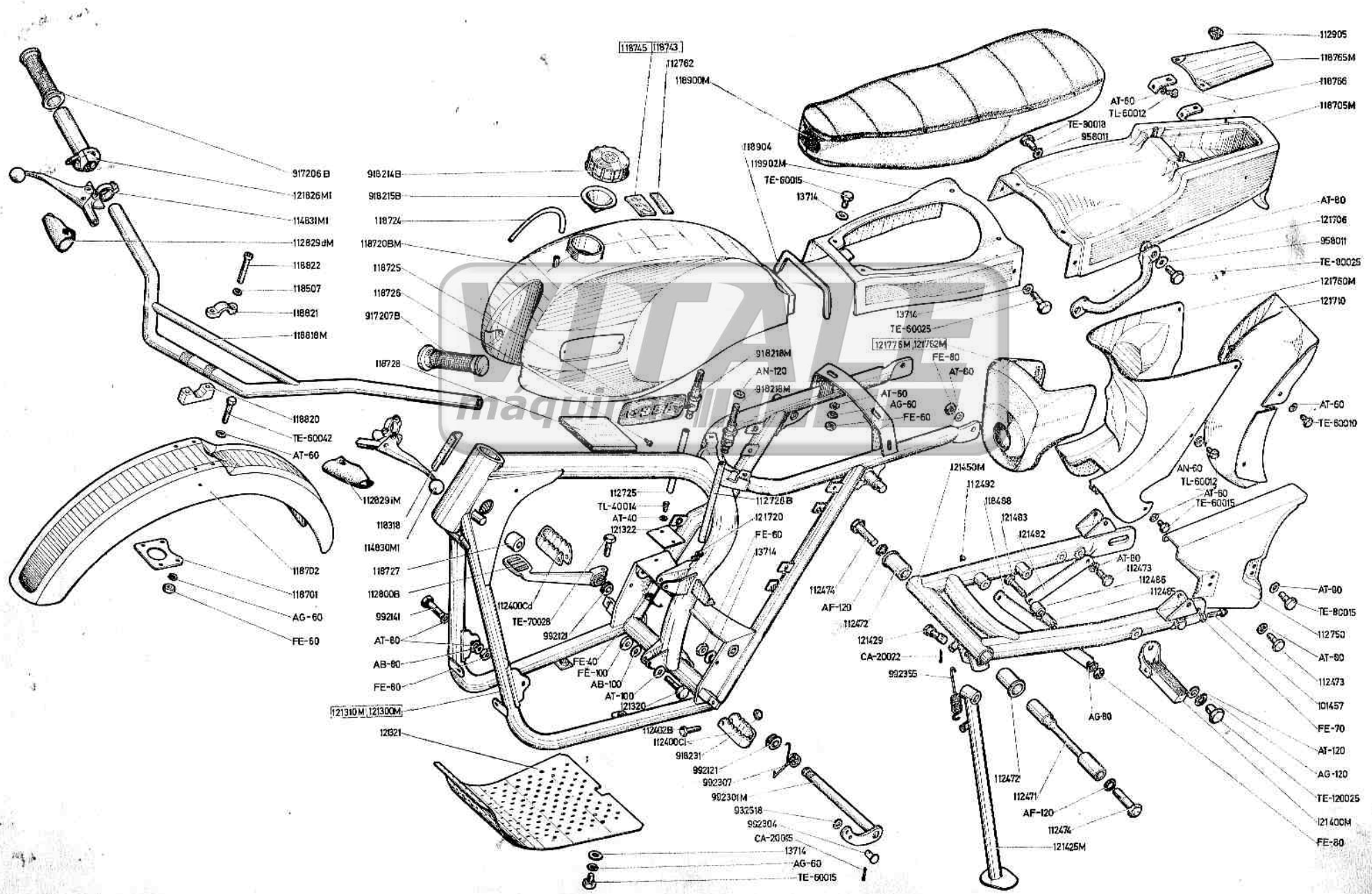

| MODEL 250 AE-71 | | SUSPENSION UNITS | | | | | | 3th. LIST |
|--------------------|---------------------------------------|------------------|------------------------|-------------|--|----------|------------------------|-----------|
| Part Number | DESCRIPTION | Quantity | Valid from unit n°r | Part Number | DESCRIPTION | Quantity | Valid from unit n°r | |
| LI-1101-11 | Spring seal | 2 | | LI-8110-11A | «O» ring 1-30 | 2 | | |
| LI-1101-12A | Guide spring seal | 2 | | LI-8114-10 | Stanchion «O» ring 26 x 32 x 3 | 2 | | |
| LI-1501-16 | Adjuster | 2 | | LI-8114-11 | Stanchion «O» ring 12 x 17 x 2,5 | 2 | | |
| LI-1514-011 | Regulating bushing | 2 | | 112.511 | Nut steering shaft | 1 | | |
| LI-1514-35 | Top grip | 2 | | 112.517 | Nut steering adjuster | 1 | | |
| LI-1514-86 | Housing for spring | 2 | | 112.518 | Felt washer | 2 | | |
| LI-1515-10 | Inner tube | 2 | | 112.519 | Dust cover | 2 | | |
| LI-1515-26 | Guide | 2 | | 112.580 BMI | Shockabsorber assembly (for 175 and 250 AS71) | 2 | | |
| LI-1520-47 | Spring (for 175 and 250 AS71) | 2 | | 118.505 | Bolt stanchion tube | 8 | | |
| LI-R-1532 | Spare part kit | 2 | | 118.506 | Bolt steering shaft | 1 | | |
| LI-1532-02 | Oil tank | 2 | | 118.507 | Washer, stanchion tube bolt | 8 | | |
| LI-1532-38 | Cover | 2 | | 118.508 | Washer, steering shaft bolt | 1 | | |
| LI-1533-47 | Spring (for 175-250 AE71 and 250 E71) | 2 | | 118.541 | Top yoke (for 175 and 250 AS71) | 1 | | |
| LI-6204-015 | Damper assembly | 2 | | 118.542 M | Bottom yoke with stem (for 175 and 250 AS71) | 1 | | |
| LI-6204-110 | Washer damper bolt | 2 | | 118.548 MI | Suspension assembly left (for 175 and 250 AS71) | 1 | | |
| LI-6208-96 | Dust cover | 2 | | 118.549 MI | Suspension assembly right (for 175 and 250 AS71) | 1 | | |
| LI-6215-01 | Right tank assembly | 1 | | 118.551 | Top yoke (for 175-250 AE71 and 250 E71) | 1 | | |
| LI-6215-02 | Left tank assembly | 1 | | 118.552 M | Bottom yoke with stem (for 175-250 AE71 and 250 E71) | 1 | | |
| LI-6215-029 | Stanchion plug | 2 | | 118.558 MI | Suspension assembly right (for 175-250 AE71 and 250 E71) | 1 | | |
| LI-6215-22 | Stanchion tube | 2 | | 118.559 MI | Suspension assembly left (for 175-250 AE71 and 250 E71) | 1 | | |
| LI-6215-47 | Spring (for 175-250 AE71 and 250 E71) | 2 | | 118.575 MI | Shockabsorber assembly (for 175-250 AE71 and 250 E71) | 2 | | |
| LI-6216-47 | Spring (for 175 and 250 AS-71) | 2 | | 914.373 | Washer schockabsorber | 4 | | |
| LI-8101-15 | Bolt M8 x 60 | 2 | | | | | | |
| LI-8101-27 | Allen bolt M8 x 25 | 2 | | | | | | |
| LI-8102-11 | Nut M8 | 2 | | | | | | |
| LI-8103-10 | Polished washer | 4 | | | | | | |
| LI-8104-10 | Spring washer | 2 | | FE-120 | Nut shockabsorber | 4 | | |
| LI-8104-16 | Spring washer | 2 | | KH-20-47-14 | Bearing assembly | 2 | | |
| LI-8105-12 | Bottom nut | 2 | | TE-120.045 | Bolt, shokabsorber | 2 | | |
| | | | | | COMMON PARTS | | | |

| EDITION | | | | |
|---------|--|--|--|--|
| 1 | | | | |
| 9-70 | | | | |

EDITION

| | | | | |
|------|--|--|--|--|
| 1 | | | | |
| 9-70 | | | | |

250-AE 71

SUSPENSION UNITS

3 SHEET

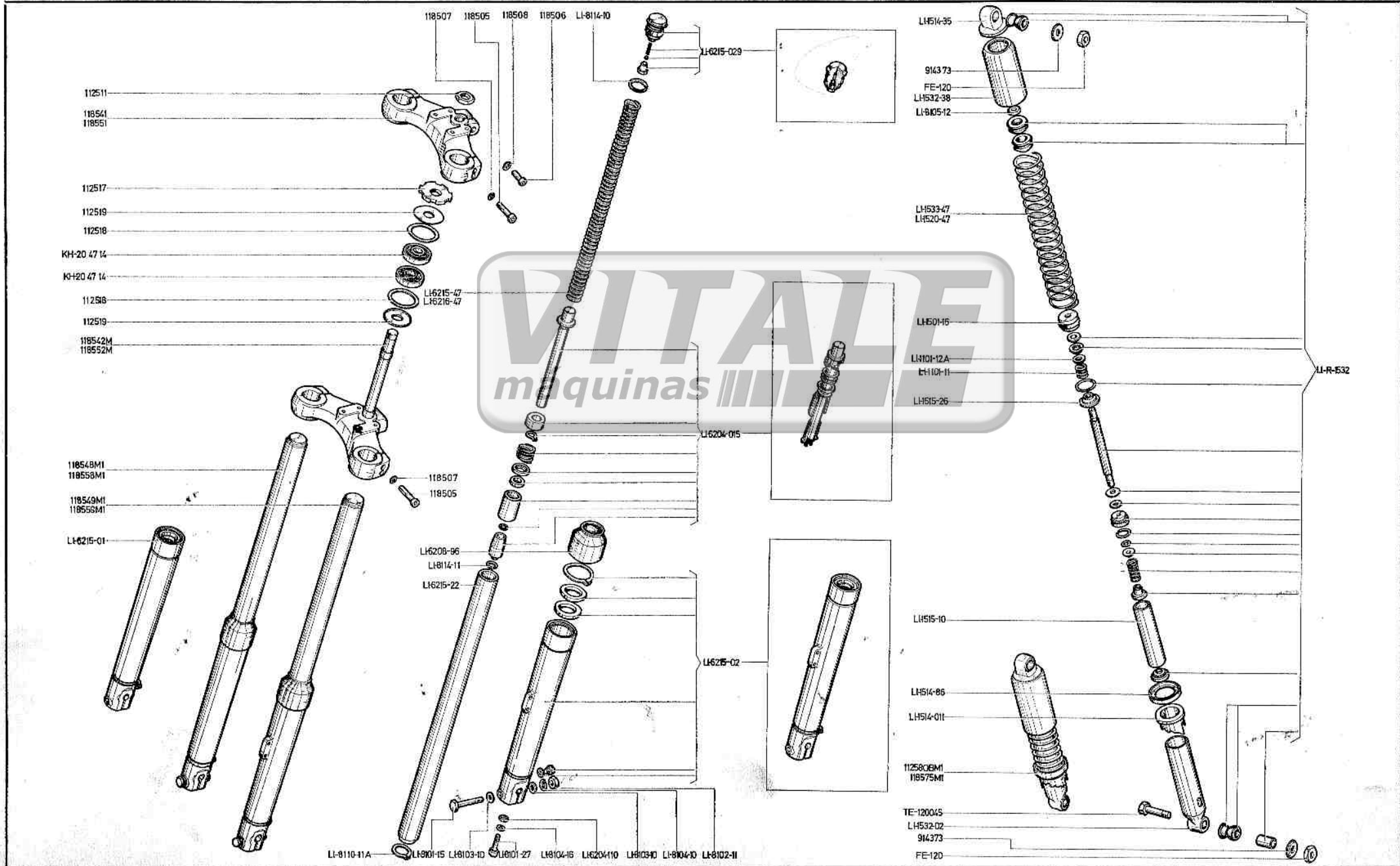

| MODEL 250 AE-71 | | WHEELS | | | | | 4th. LIST |
|--------------------|--|----------|------------------------|---------------|---|----------|------------------------|
| Part Number | DESCRIPTION | Quantity | Valid from unit n°r | Part Number | DESCRIPTION | Quantity | Valid from unit n°r |
| 101.661 B | Bolt rear sprocket | 8 | | 914.364 | Bolt anchor plate | 2 | |
| 112.602 M | Front axle assembly | 1 | | 923.315 | Nut backing plate | 1 | |
| 112.604 | Nut backing plate shaft | 1 | | 943.354 | Bolt backing plate | 1 | |
| 112.605 | Shaft backing plate | 1 | | 943.355 BM | Brake cam assembly | 2 | |
| 112.607 | Spacer front wheel | 1 | | 943.360 | Spring brake choe | 4 | |
| 112.614 MI | Tyre dog | 2 | | 943.362 | Felt washer | 4 | |
| 112.619 MI | Front hub assembly 19" with brake | 1 | | 943.364 B | Front brake am | 1 | |
| 112.621 MI | Front hub assembly 19" | 1 | | 943.367 | Thrust washer | 2 | |
| 112.632 | Innertube | 1 | | 943.372 | Washer brake cam | 2 | |
| 112.633 | Rubber innertube | 1 | | 944.355 M | Backing plate | 2 | |
| 112.638 | Spoke nipples | 72 | | 944.357 M | Bearing cover (for 175-250AS) | 1 | |
| 112.641 | Front tyre | 1 | | 944.367 | Nut rear axle | 1 | |
| 112.646 | Reem 21" | 1 | | 993.303 | Spacer front wheel | 1 | |
| 112.651 M | Rear axle assembly | 1 | | 993.304 | Spacer busting front wheel (175-250AE-250E) | 1 | |
| 112.658 | Innertube | 1 | | 993.305 | Aligning washer spacer tube | 4 | |
| 112.659 | Rubber innertube | 1 | | 993.309 | Felt washer | 1 | |
| 112.660 | Reem | 1 | | 993.357 dMI | Front leading brake shoe | 2 | |
| 112.664 MI | Tyre dog | 2 | | 993.357 tMI | Trailing brake shoe | 2 | |
| 112.671 | Rear tyre | 1 | | 994.303 | Spacer tube rear wheel | 1 | |
| 112.695 BMI | Secondary chain (for 250-175 AS) | 1 | | 994.312 B | Rear brake arm | 1 | |
| 114.609 MI | Front hub assembly with brake 21" | 1 | | 994.313M | Anchor plate rear wheel | 1 | |
| 114.611 MI | Front hub | 1 | | | | | |
| 114.620 | Reem 19" | 1 | | | | | |
| 114.621 | Spokes for 19" wheel | 36 | | | | | |
| 118.606 | Arm anchor plate | 1 | | | | | |
| 118.611 MI | Speedo drive assembly (for 175-250 AE-250 E) | 1 | | | | | |
| 121.603 | Spokes (innerside) front wheel | 18 | | | | | |
| 121.604 | Spokes (outerside) front wheel | 18 | | | | | |
| 121.648 MI | Rear hub assembly with brake | 1 | | | | | |
| 121.649 MI | Rear hub assembly | 1 | | | | | |
| 121.650 M | Rear hub | 1 | | | | | |
| 121.651 | Rear sprocket (for 175-250 AE-250E) | 1 | | AG-60 | Washer anchor arm | 2 | |
| 121.652 | Rear sprocket (for 175-250AS) | 1 | | AG-80 | Washer rear spocket | 8 | |
| 121.653 | Rear sprocket (for 175-250AS) z=57 | 1 | | AG-100 | Washer backing plate | 4 | |
| 121.655 | Spokes (innerside) rear wheel | 18 | | AT-60 | Washer Front anchor arm | 2 | |
| 121.656 | Spokes (outerside) rear wheel | 18 | | AT-140 | Washer front axle | 1 | |
| 121.657 M | Bearing cover rear wheel | 1 | | GR-60 | Grease Fitting | 2 | |
| 121.658 MI | Secondary chain (for 175-250AE-250E) | 1 | | FE-60 | Nut front anchor arm | 2 | |
| 121.659 | Left washer rear axle | 1 | | FE-140 | Nut front axle | 1 | |
| 121.660 | Right washer rear axle | 1 | | KC-15-42-13RS | Wheel bearing with dust cover | 4 | |
| | | | | TE-60022 | Bolt, brake arm and anchor arm | 4 | |

COMMON PARTS

EDITION

| | | | | |
|------|--|--|--|--|
| 1 | | | | |
| 9-70 | | | | |

| EDITION | | | |
|---------|--|--|--|
| 1 | | | |
| 9-70 | | | |

WHEELS

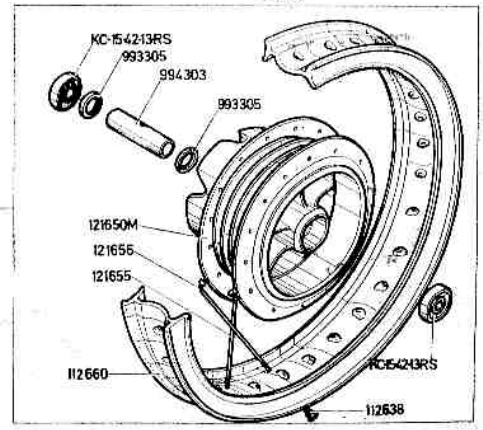
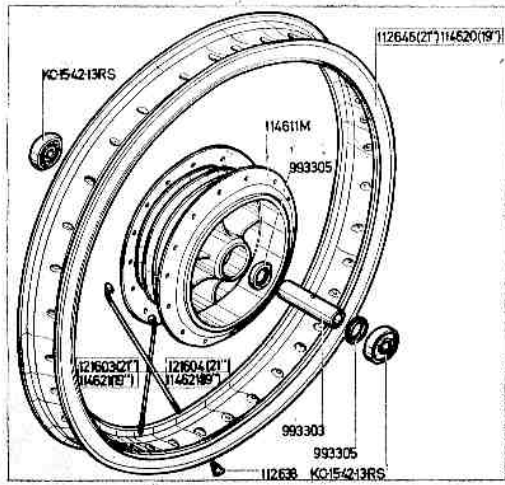
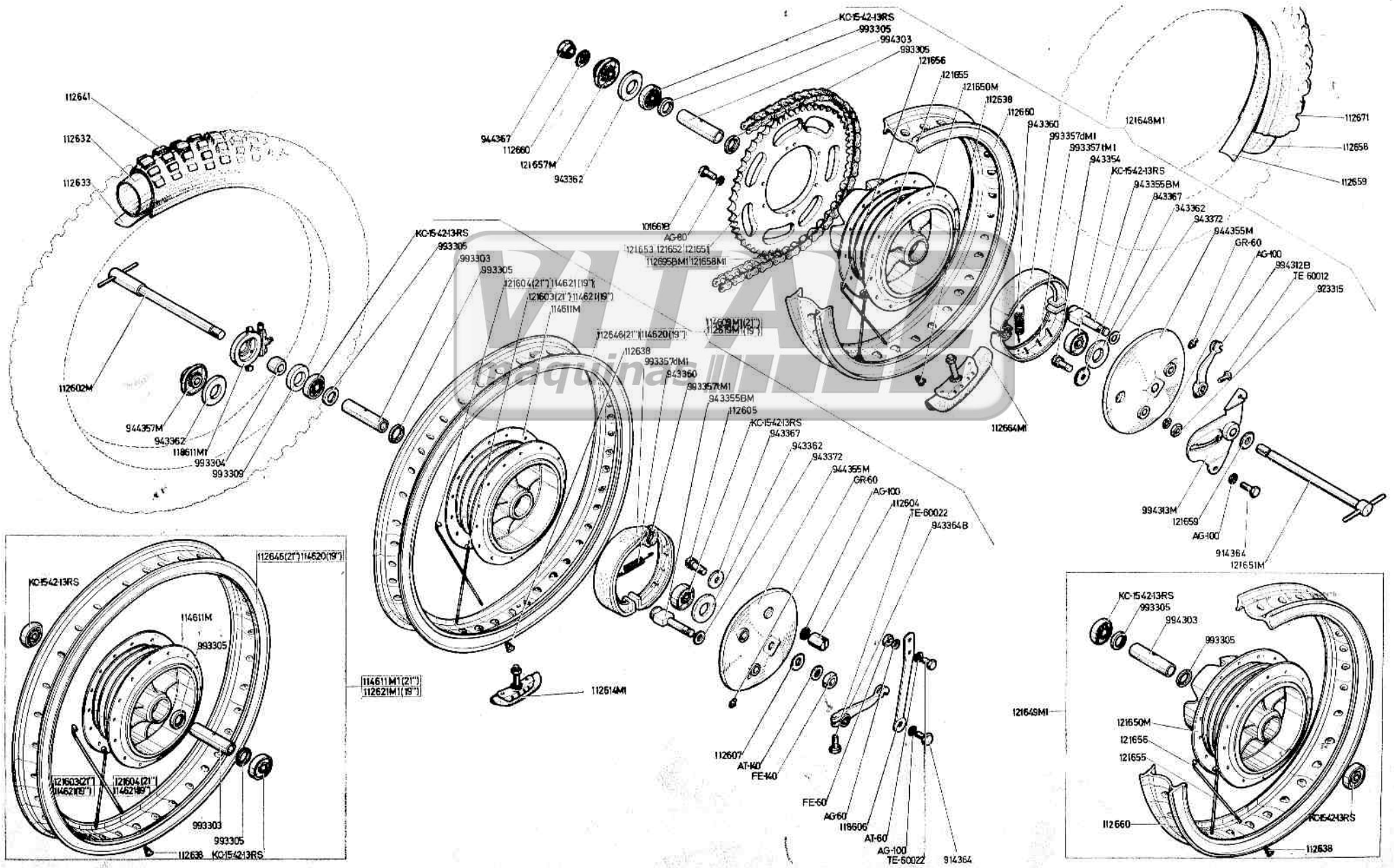

| EDITION | | | |
|---------|--|--|--|
| 1 | | | |
| 9-70 | | | |

ELECTRICAL ASSEMBLY AND EXHAUST COMPONENTS 5 SHEET

